



THE COOK SHACK

Centrally located in the Village at Paws Up, the Cook Shack features a variety of Montana-inspired meeting facilities. The Tower Boardroom,



located in the Cook Shack's iconic turret, is a quaint meeting space for up to 10 people and features a panoramic mountain view.

Pomp, our award-winning gourmet restaurant, seats up to 85 people – perfect for a memorable group dinner. Trough, our casual-dining restaurant features a fun and unique western ambience for up to 65 people. Tank is our full-service bar – ideal for unwinding after a day of meetings and activities.

A gorgeous deck with stunning views surrounds the entire building.

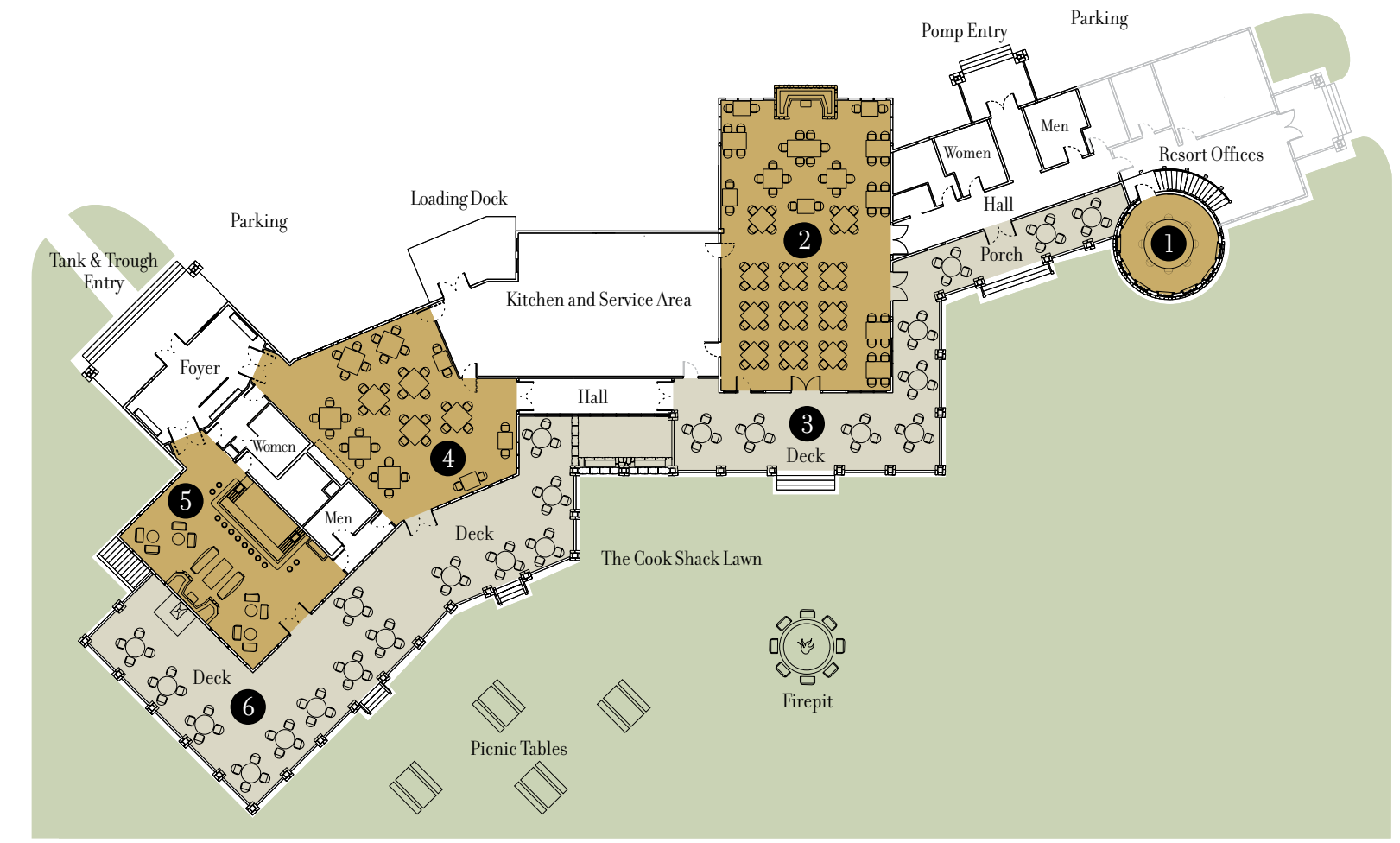

KEY AND CAPACITIES		Square Footage	Dimensions (LxW)	Theater	Classroom	U-Shape	Hollow Square	Conference	Banquet	Reception
	The Cook Shack	5,057								
1	Tower Boardroom	314		–	–	–	–	10	–	–
2	Pomp	2,100	60 x 35	65	60	24	30	30	80	150
3	Pomp - Exterior Deck	1,575							40	75
4	Trough	1,512	36 x 42	66	50	30	40	30	66	115
5	Tank	1,131	29 x 39	–	–	–	–	–	–	50
6	Tank and Trough - Exterior Decks	2,560		55	–	15	–	55	55	110