

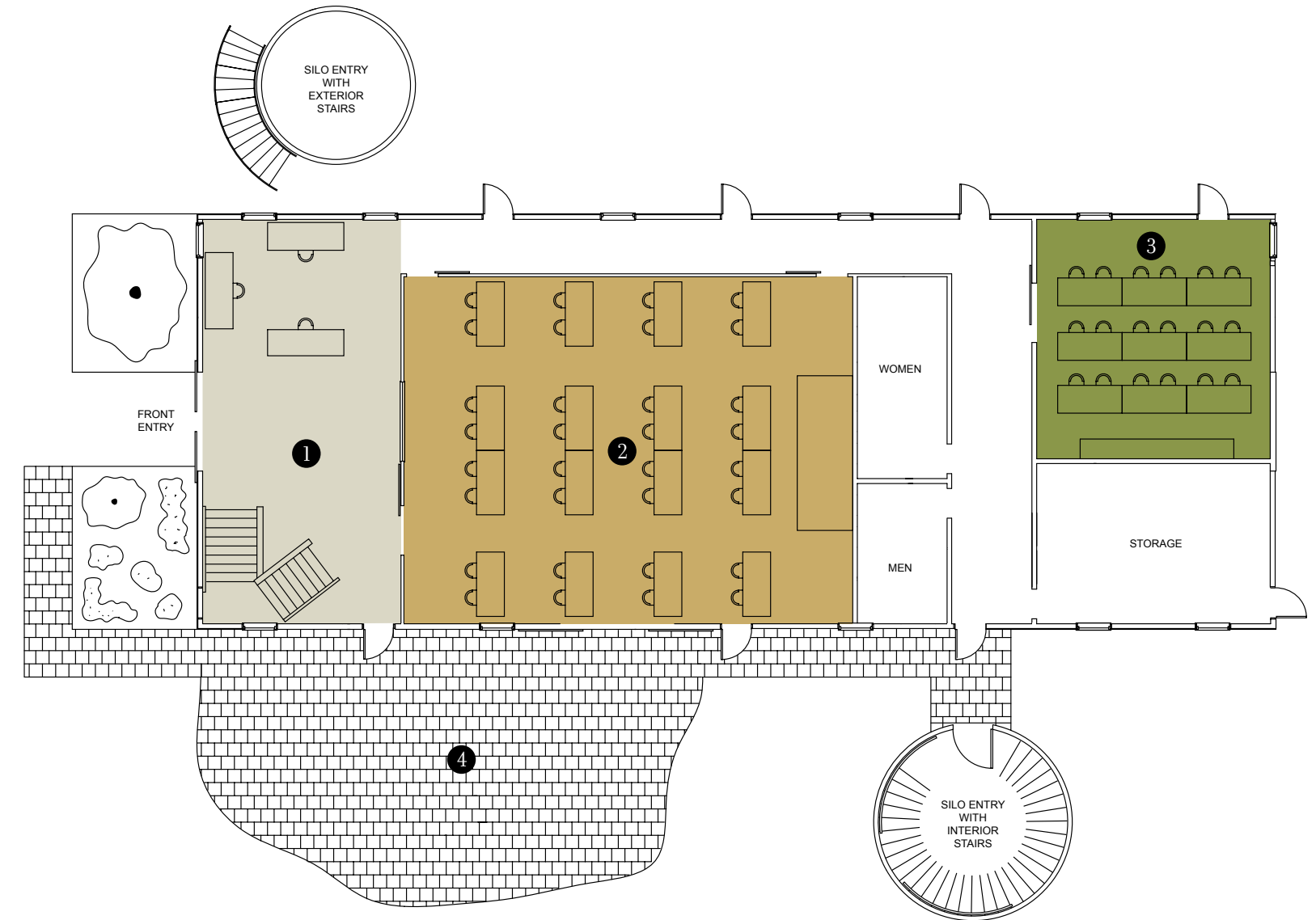

## THE BULL BARN CONFERENCE FLOOR

The Bull Barn is an authentic Montana cattle barn that has been newly renovated into a world-class conference center and special event hall. The Conference Floor features two meeting rooms – Hereford Pen and Shorthorn Pen – providing an ideal setting and state-of-the-art audio-visual technology for successful presentations of any kind. Large, authentic sliding barn doors open to the Bull Pen Patio, allowing events to expand to the breathtaking outdoors for breaks and receptions.



Key and Capacities		Square Footage	Dimensions (L x W)	Theater	Classroom	U-Shape	Hollow Square	Conference	Banquet	Reception
<b>The Bull Barn Conference Floor</b>		4,536	108 x 42							
1	Reception Area and Business Center	520	20 x 26	–	–	–	–	–	–	–
2	Hereford Pen	1,665	45 x 37	80	80	70	60	60	75	80
3	Shorthorn Pen	625	25 x 25	25	25	18	15	15	25	25
4	Bull Pen Patio	1,680	48 x 35	–	–	–	–	–	75	100



## THE BULL BARN GREAT ANGUS HALL

The Great Angus Hall is an expansive banquet venue that features 3,145 square feet of space complete with a soaring vaulted ceiling and

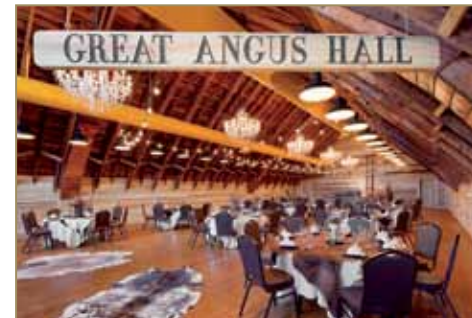

audio-visual equipment. This prodigious room in the upper level of the Bull Barn – formerly used for hay storage – serves as the perfect space for large

events of all types. The exposed rafters, blue-stain pine wood paneling and dramatic chandeliers give this grand restored hayloft a rustic, yet sophisticated ambiance. The hall is ideal for weddings, receptions and social gatherings of any kind for up to 200 people. Countless configuration options are available to customize your special event.

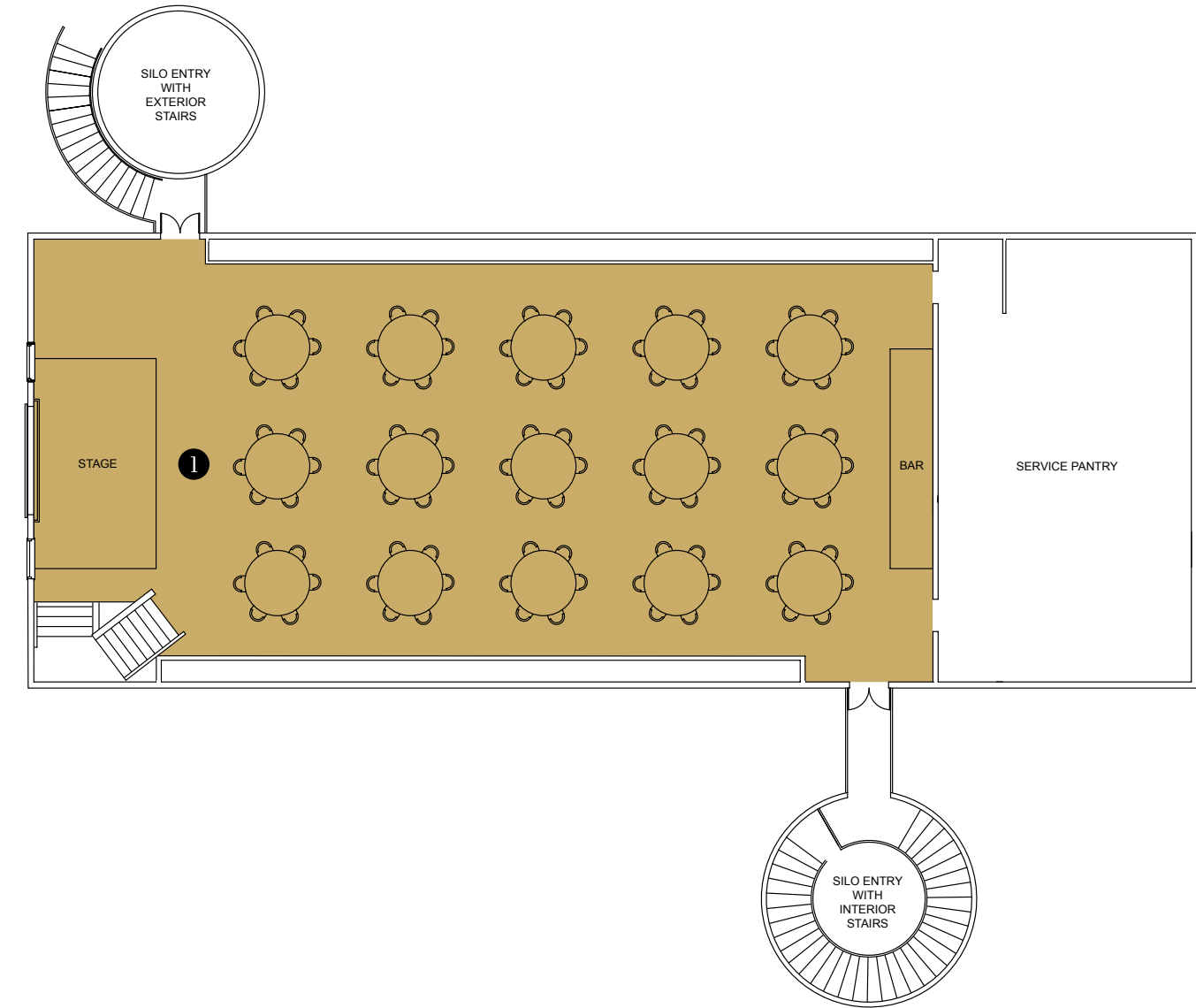

Key and Capacities		Square Footage	Dimensions (L x W)	Theater	Classroom	U-Shape	Hollow Square	Conference	Banquet	Reception
	<b>The Bull Barn Second Floor</b>	4,536	108 x 42							
1	Great Angus Hall	3,145	85 x 37	175	150	100	85	85	175	200