

CREEKSIDE CAMP



Creekside Camp is situated on the banks of the beautiful and pastoral Elk Creek and features six spacious tent suites: four two-bedroom suites and two one-bedroom suites. Each tent comes with The Last Best Bed and an en suite bathroom with a two-sink vanity and a large slate shower. Creekside Camp also has an architecturally impressive Dining Pavilion with a monumental stone-and-timber fireplace, as well as an outdoor fire pit—perfect for a night of stories and s'mores. The gorgeous mountain setting of Creekside Camp will frequently remind you that you're in *The Last Best Place*.

FEATURES AND AMENITIES

- 505- and 830-square-foot tents
- Electricity, air conditioning and heat
- Three two-bedroom tent suites, each featuring a king and two twin beds
- Expansive deck with Adirondack chairs
- One two-bedroom tent suite with king, twin and bunk bed
- Dining Pavilion with a lounge, fireplace and views of Elk Creek
- Two one-bedroom tent suites, each featuring a king bed
- Camping butler and camp chef
- En suite bathrooms, each featuring a slate shower, a vanity with double sinks and a heated slate floor
- Daily full-service housekeeping
- Nightly bonfire with s'mores
- Laundry
- Cell and Internet service
- Access to Camper's Beach

ONE-BEDROOM TENT WITH EN SUITE BATHROOM

505 SQUARE FEET

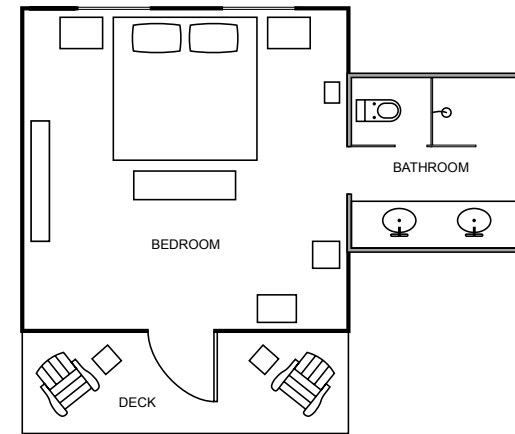

TWO-BEDROOM TENT WITH EN SUITE BATHROOM

830 SQUARE FEET

