

C L I F F S I D E C A M P



Located near Paws Up's famous covered bridge and atop a soaring cliff that overlooks the confluence of the Blackfoot River and Elk Creek, Cliffside Camp combines luxurious amenities with The Resort's most stunning views to create the ultimate glamping experience in Montana. Four two-bedroom tent suites feature plenty of room for families, while two one-bedroom honeymoon tents, complete with a copper tub for two, serve as the quintessential accommodations for romantic getaways.

FEATURES AND AMENITIES

- 605- and 975-square-foot tents
- Expansive deck with seating
- Four two-bedroom tent suites, each featuring a king and two twin beds
- Dining Pavilion with mountain views
- Two one-bedroom tent suites, each featuring a king bed
- Camping butler and camp chef
- Daily full-service housekeeping
- Nightly bonfire in fire pit with s'mores
- En suite bathrooms, each with a slate shower, a vanity with double sinks and a heated slate floor
- Laundry
- Cell and Internet service
- Electricity, air conditioning and heat
- Access to Camper's Beach

ONE-BEDROOM TENT WITH EN SUITE BATHROOM
605 SQUARE FEET

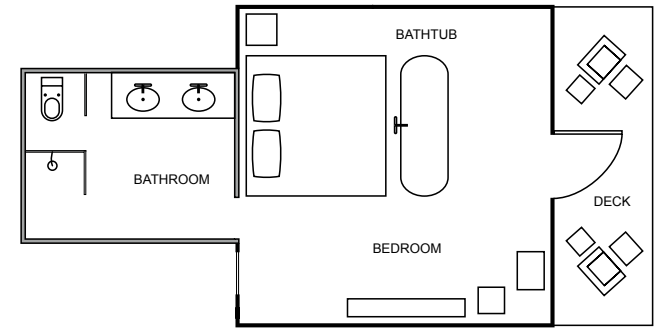

TWO-BEDROOM TENT WITH EN SUITE BATHROOM
975 SQUARE FEET

